



# TABLE OF CONTENTS

**INTRODUCTION TO THE MACHINE ..... 2**

**I. SAFETY INFORMATION ..... 3**

- Section 1.01: Important Safety Notice..... 3

- Section 1.02: Important Safety Instructions..... 5

**II. FEATURES & SPECIFICATIONS ..... 9**

- Section 2.01: Features..... 9

- Section 2.02: Specifications..... 10

- Section 2.03: Machine Overview..... 11

**III. OPERATING INSTRUCTIONS ..... 12**

**IV. TROUBLESHOOTING & MAINTENANCE ..... 20**

- Section 4.01: Common Problems / Solutions ..... 20

- Section 4.02: Maintenance Procedures ..... 20

**V. REPLACEMENT PARTS ..... 18**

**WARRANTY ..... 20**

## CUSTOMER SERVICE CONTACT INFORMATION

For product information, tech support, or to order replacement parts, call:

**1-800-303-5874**



# INTRODUCTION

to the ProMax40

*Congratulations on the purchase of your Flo-Dynamics ProMax40 automatic transmission fluid exchanging machine!*

Simply put, this machine is the cleanest, safest, easiest, fastest, most thorough, and most cost-efficient method of fluid exchange ever devised. Suddenly, regular automatic transmission and power steering maintenance become a more realistic proposition. Transmission and power steering fluid exchanging are cleaner and neater than ever!

***Transmission Fluid Exchange:***

To attain the highest level of protection for internal transmission components and increase the transmission's life span to the maximum, it is recommended that the transmission's lubrication system is serviced every 15,000 miles (or according to the vehicle owner's manual). The Flo-Dynamics ProMax40 exchanges virtually all of the used transmission fluid to new, without even requiring the transmission pan to be dropped. There is no spillage, and no mess.

- **The ProMax40 can be used practically anywhere – and with almost any vehicle.**
- **It is compact, mobile, and self-contained.**
- **It operates off the 12-volt battery of the vehicle being serviced.**
- **It does not require a pit, lift, or ramp.**
- **The ProMax40 hooks up directly to one of the vehicle's transmission cooler lines for a transmission fluid exchange.**
- **The ATF fluid exchange, from setup to finish, typically takes 15 minutes or less!**
- **The ProMax40 Conforms with OEM specifications in exchanging only 100% transmission fluid. Using aftermarket cleaners and solvents when exchanging or flushing is not approved by OEM Engineering.**

No wonder an ATF exchange is the most requested method of preventative automatic transmission maintenance today.

**Please take time to read through this manual to familiarize yourself with the ProMax40 before performing your first ATF exchange.**

# I. SAFETY INFORMATION

## 1.01 IMPORTANT SAFETY NOTICE

For your safety, read this manual thoroughly before operating your ProMax40 unit. Your ProMax40 unit is intended for use by properly trained, skilled professional automotive technicians. The safety messages presented below and throughout this user's manual are reminders to the operator to exercise care when using this unit. Before using your ProMax40, always refer to and follow the safety messages and applicable service procedures provided by the manufacturer of the vehicle being serviced.

### • Read All Safety Instructions

Read, understand and follow all safety messages and instructions in this manual. Safety messages in this section of the manual contain a signal word with a three-part message and, in some instances, an icon.

### • Signal Words

The signal word indicates the level of the hazard in a situation:

*Indicates an imminently hazardous situation which, if not avoided, will result in death or serious injury to the operator or to bystanders.*

*Indicates a potentially hazardous situation which, if not avoided, could result in death or serious injury to the operator or to bystanders.*

*Indicates a potentially hazardous situation which, if not avoided, may result in moderate or minor injury to the operator or to bystanders.*

*Indicates a situation which, if not avoided, may result in damage to the ProMax40 or the vehicle being serviced.*

### • Safety Messages

Safety messages in this section contain three different type styles:

- Normal type states the hazard.
- **Bold type** states how to avoid the hazard.
- *Italic type* states the possible consequences of not avoiding the hazard.

**• Safety Symbols**

A safety symbol, when present, gives a graphical description of the potential hazard, and how to avoid the hazard:

**Risk of Fire**

**Read Instructions Before Use**

**Risk of Explosion**

**Mandatory Eye Protection**

**Risk of Entanglement**

**Mandatory Protective Gloves**

**Dangerous Fumes**

**Mandatory Protective Clothing**

**Do Not Pull or Move**

## 1.02 IMPORTANT SAFETY INSTRUCTIONS

Engine exhaust contains toxic gases.

- **Vent vehicle's exhaust away from work area.**
- **Do not breathe exhaust.**

*Exhaust gases will cause injury or death.*

Improper use and operation.

- **Read, understand and follow all safety messages and operational procedures in this manual before operating the Flo-Dynamics ProMax40.**
- **This equipment should be operated only by qualified personnel.**
- **Use this equipment only as described in this manual.**

*Improper use and operation of this product can result in injury.*

Engine systems can malfunction expelling fuel, oil vapors, hot steam, hot toxic exhaust gases and other debris.

- **Wear safety goggles and protective clothing, user and bystander.**

*Engine systems that fail can cause serious injury.*

Risk of expelling pressurized fluids.

- **Wear safety goggles and protective clothing, user and bystander.**
- **Verify that engine and machine are off before connecting or disconnecting cooler lines and adapter hoses.**
- **Always unplug the machine from its power source when not in use.**
- **Keep the service hoses away from hot or moving engine parts. Hoses can split or burst causing fluid to be expelled.**
- **Tighten all connections properly. Insufficient or excessive torque can result in fluid leakage.**
- **Avoid contact with automatic transmission or power steering fluid.**
- **Treatment methods are as follows:**
  - Eyes: Flush eyes with plenty of water.**
  - Skin: Wash with soap and water.**

**Inhalation:** Move to uncontaminated area.

**Ingestion:** If large amount, get medical attention.

**If any irritation persists, get medical attention.**

- **Dispose of used fluid according to environmental laws and regulations.**

*Although automatic transmission and power steering fluid pose no significant health hazards, some individuals may experience adverse reactions upon contact. Pressurized fluid can cause serious injury.*

## **WARNING**

Risk of unexpected vehicle movement.

- **Block drive wheels before starting vehicle's engine to begin an exchange.**
- **Unless instructed otherwise, set parking brake and put gear selector in park.**
- **Do not leave a running vehicle unattended.**

*A moving vehicle can cause injury.*

## **WARNING**



Engine has moving parts. Risk of entanglement.

- **Do not place tools on fenders or other places in engine compartment.**
- **Keep yourself, clothing, battery cables and service hoses clear of moving parts such as fan blades, belts and pulleys.**

*Contact with moving parts can cause injury.*

## **WARNING**



Risk of fire or explosion.

- **Do not operate the ProMax40 in the vicinity of open containers of flammable liquids such as gasoline.**
- **Keep hoses and jumper cables away from heat sources and sharp edges.**
- **Do not operate equipment with damaged cords or hoses until they have been examined by a qualified serviceman.**

*Fire or explosion can cause injury.*

## **WARNING**



Risk of fire or explosion. Gases produced by a battery are highly explosive.

- **Wear safety goggles and protective clothing, user and bystander.**
- **This machine is equipped to operate on 12-volt DC power only. A power source greater than this can result in serious injury to the user as well as damage to the machine.**
- **Do not smoke, place metal tools on battery or allow a spark or flame in vicinity of battery.**
- **Clean battery terminals before hooking the machine's battery clips to them. During cleaning, keep airborne corrosion from eyes, nose and mouth.**

- Be sure both battery cables are tightly connected to the battery terminals as instructed before proceeding with a fluid exchange.
- Never remove battery cables from the battery terminals while the machine is operating. Only use the “EMERGENCY STOP” button located on the control panel to stop an exchange.

*Battery explosion can cause injury.*

## WARNING



Battery acid is a highly corrosive sulfuric acid.

- Wear safety goggles and protective gloves, user and bystander.
- Have plenty of fresh water and soap nearby. If battery acid contacts skin, clothing, or eyes, flush exposed area with soap and water for 10 minutes.
- While cleaning battery's terminals, keep airborne corrosion from eyes, nose and mouth.
- Do not touch eyes while working near battery.

*Battery acid can burn eyes and skin.*

## WARNING



Risk of burns.

- Wear gloves when working near hot engine components.
- Do not touch hot exhaust systems, manifolds, engines, radiators, etc.
- The automatic transmission fluid coming from the vehicle along with some of the machine's components that the fluid comes into direct contact with (i.e. external: hoses and quick-disconnect fittings; internal: hoses and all fittings) may reach temperatures uncomfortable to the touch. Exercise caution in avoiding contact with these items.

*Hot components can cause injury or discomfort.*

## CAUTION

Ratchet mechanisms and tools may slip or break if dirty. Mismatched or partially worn parts can cause ratchet or any tool to slip or break.

- Frequently inspect and clean any tools used, and lubricate all non-sealed ratchet mechanisms with light oil.
- Do not replace worn parts individually. If adapter hose fittings become worn, see “Appendix C – Replacement Parts” to order new hoses.
- The use of any other accessories not specified in this manual may create a hazard.

*Tools that slip or break can cause injury.*



Risk of injury.

- This equipment should be operated by qualified personnel only.
- Use this equipment only as described in this manual.
- Always unplug the machine from its power source when not in use.
- Loop the power cord loosely in its proper location when machine is not in use.
- Do not operate equipment with a damaged battery cables or hoses, or if the equipment has been dropped or damaged, until it has been examined by a qualified service representative.
- Care should be taken to arrange the battery cables and service hoses so that they will not be tripped over or pulled.
- Never pull on the power cables or service hoses to transport the ProMax40. Damage may occur to these components, or machine may tip over.
- Keep area of operation clear of unnecessary tools and equipment. Utilize recessed tool storage areas on the top of the machine.
- Never leave the machine running unattended.
- The ProMax40 is not designed for any other purpose than the exchanging of automatic transmission and power steering fluid.

*Operation of your ProMax40 unit by anyone other than qualified personnel may result in injury.*

## IMPORTANT

Risk of equipment damage.

- Flushing high mileage cars that have not been previously serviced can cause operating problems in the transmission.
- Connect battery cables to a 12-volt power source only (i.e. vehicle's battery).
- Servicing, transporting, or storing this machine in an attitude other than the normal operating position can result in fluid spillage and/or component damage.
- Use only the manufacturer's recommended attachments.
- The Flo-Dynamics ProMax40 is fully automatic. Refer to your control panel at all times.
- Never pull on the power cables or service hoses to transport the ProMax40. Damage may occur to these components, or machine may tip over.
- Periodically clean the machine by wiping down with a clean, soft, dry cloth.

*Improper operation of equipment may result in damage to machine or components.*

**SAVE AND FOLLOW THESE INSTRUCTIONS!**



## II. FEATURES & SPECIFICATIONS

### 2.01 FEATURES

#### Mechanical Features

- Accurate sensor technology allows optimum fluid level to be maintained in vehicle's transmission.
- Two in-line 22-micron absolute fluid filters capture microscopic particles and contaminants.
- Numbered quick-disconnect hoses with adapters save time in identifying the proper hoses for the application
- Easy to use adapters allow quick hookup to virtually any automobile make and model, saving time and money.
- Diverter valve reverses fluid flow without having to switch hoses.
- Clear service hoses give visual confirmation of new and waste fluid movements.
- Ergonomically correct working height means greater productivity, less stress and strain.
- Durable roto-cast polyethylene body and tanks prevent vehicle damage. The unit is also lightweight and durable, for easier handling and longer life.
- Large 5-inch locking caster wheels make machine easy to maneuver.
- Easy-access service panel provides hassle-free operations for greater efficiency.

#### Electronic Features

- Self-contained battery cables hook up to the vehicle's 12-volt battery
- Automatic monitoring of fluid in new and waste fluid tanks assures safe operation
- Accurate sensor technology (+/- 3%)
- Digital counter display with cumulative ATF options
- Indicating lamps are activated to show all machine operations and status functions
- Ability to exchange anywhere from 1 to 35 quarts in 1 quart intervals
- Fluid measurements can be changed from quarts to liters
- Drain waste fluid tank (no need to tip machine upside-down)
- Drain new fluid tank
- Add new fluid to transmission in 1/4 quart increments (approx. 1/8" on the dipstick)
- Remove fluid from transmission in 1/4 quart increments (approx. 1/8" on the dipstick)
- Cycle valves feature allows you to electronically clean out valves
- Totalizer check (indicates lifetime use)
- Interactive options menu:
  - "Auto Prime" feature automatically primes the system
  - Indicate new fluid volume
  - Indicate waste fluid capacity
  - Read battery voltage

## **2.02 SPECIFICATIONS**

### **DIMENSIONS:**

39" Tall  
24 3/4" Wide  
25" Deep

#### **Service Hoses:**

10' outside of machine

#### **Wheels:**

5" locking casters (front)  
5" casters (back)

#### **Fluid Tanks:**

40-Quart New Fluid Tank  
40-Quart Waste Fluid Tank

#### **Weight:**

140 lbs

### **TECHNICAL SPECIFICATIONS:**

#### **Power:**

12-Volt DC from vehicle battery

#### **Fuse:**

15 Amp

#### **Fluid Sensors:**

+/- 3% accurate sensors

#### **Filters:**

25-micron absolute fluid filters

#### **Operating Temperature:**

60° to 150°F (15° to 65°C)

## 2.03 MACHINE OVERVIEW

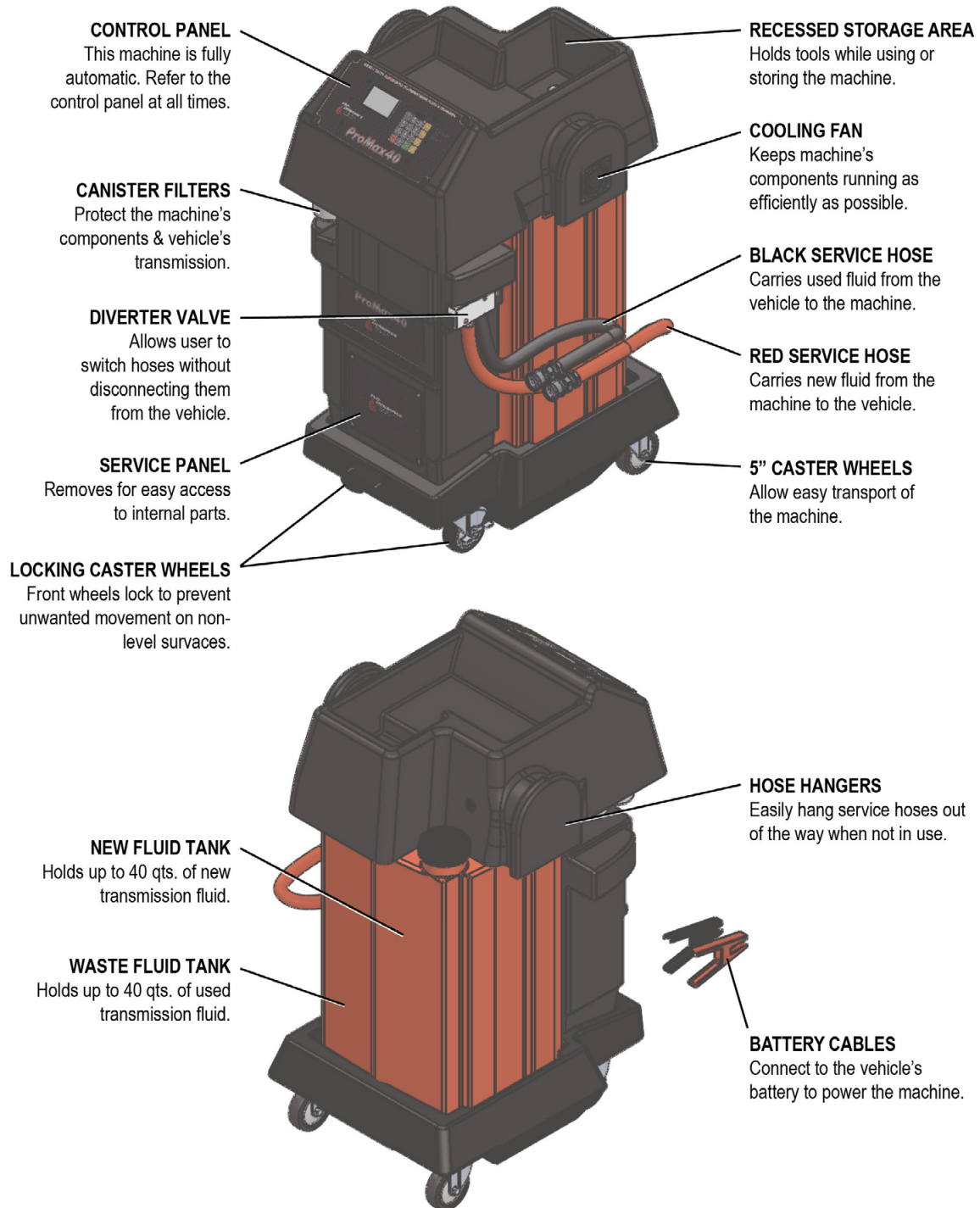

## III. OPERATING INSTRUCTIONS

### OPERATION

**NOTE:** This machine is fully interactive. Always follow the on-screen instructions.

#### SAFETY RECOMMENDATIONS

- Use extreme safety measures when working around a running engine.
- Always block the vehicle's drive wheels.
- Ventilate the vehicle's exhaust.
- Always wear safety glasses.
- It's a good idea to wear gloves.

#### PREPARATION

- Road test the vehicle for at least one mile.
- Make sure there are no problems with the transmission such as leaks, low fluid level, shifting issues, etc.
- Connect battery cables to vehicle's battery.



#### PERFORMING AN INLINE EXCHANGE

Press 1 for Inline Exchange.

***Vehicles with Internal Transmission Thermostats:***

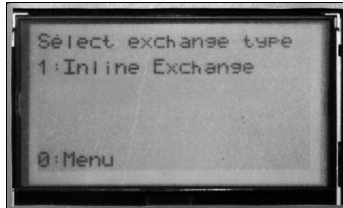

Before a transmission fluid exchange service can be performed, refer to O.E. recommended procedure to ensure transmission fluid flow through transmission cooler.

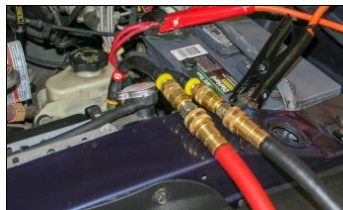

Connect appropriate adapters to vehicle's cooler line fittings. Connect the red and black service hoses to the quick disconnect adapters on the end of the cooler line adapters.

Use the yellow ▲ ▼ arrow keys to select the desired amount to be exchanged. Press the **Green Button** to proceed.

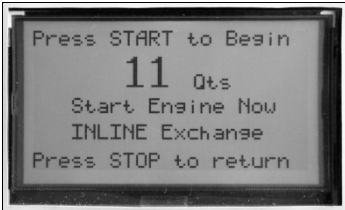

Start the vehicle's engine when the display prompts you to do so. Then press the <b>Green Button</b> to begin the exchange.	
Once the exchange is finished, the screen will beep and display "Complete".	 

### FUNCTIONS USED DURING AN EXCHANGE

Press <b>0</b> at any time to return to the main menu.	 
<p>If needed, while running, press the <b>Red Button</b> once to pause the exchange.</p> <p>Press the <b>Green Button</b> to resume from pause.</p> <p>Press the <b>Red Button</b> a second time to cancel the exchange.</p>	 
<p><b>When checking the fluid level:</b></p> <p>Press + or – to add or remove fluid in 2/10 of a quart increments.</p> <p>Use <b>Option 3</b> in the main menu to add a full quart, and <b>Option 4</b> to remove a full quart.</p>	 
If the exchange stops and the display reads "Halted – Reverse Hoses", push or pull the knob on the flow diverter valve to switch directions, and press the <b>Green Button</b> to resume the exchange.	 

If the exchange stops and the display reads **"Halted – Shift to Neutral"**, set the vehicle's parking brake, shift to neutral, and press the **Green Button** to resume the exchange.



## ADDITIONAL FUNCTIONS

### MAIN MENU

Press **0** at any time to return to the main menu.

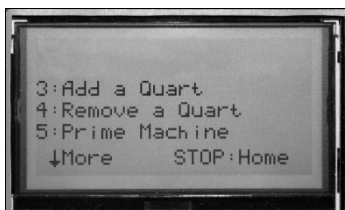

### PRIMING THE MACHINE

Press **5** to select **Prime Machine**.

The machine will prompt you to join the red and black service hoses.

Make sure there is fluid in the new fluid tank.

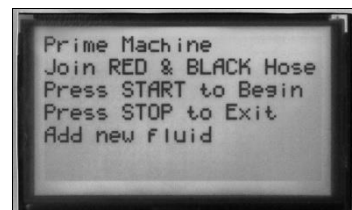
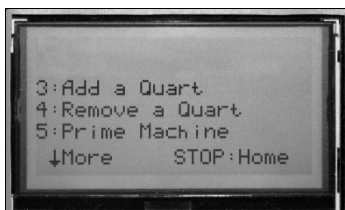

Connect the red and black service hoses together using any two mating adapters.

Press the **Green Button** to begin the process.

The unit will shut off when complete.

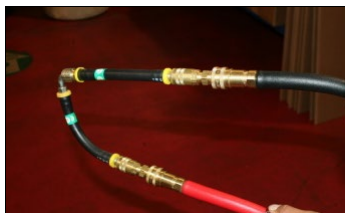



### DRAINING THE TANKS

From the main menu, press ▼ to proceed to the next menu. Press **6** to drain the **NEW FLUID** tank, or **7** to drain the **USED FLUID** tank.

To **fully** drain a fluid tank, press ▼ *twice* from the main menu. Press **1** to fully drain the **NEW FLUID** tank, or **2** to fully drain the **USED FLUID** tank. After fully draining either fluid tank, the machine must be primed.



Connect any open-ended adapter to the **red** service hose and insert into an appropriate disposal container. **Make sure all other hoses are disconnected!**

Press the **Green Button** to begin the process.

The unit will shut off when complete.

**NOTE:** When **fully** draining a tank, the machine will not stop automatically when the tank is empty. You must push the **Red Button** on the control panel when the machine begins to pump air out of the red service hose.

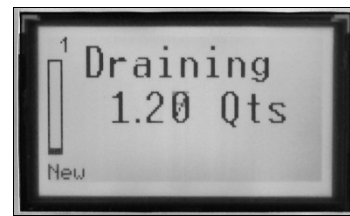

### VOLTAGE MONITOR

From the main menu, press ▼ to proceed to the next menu. Press **8** to display the voltage.



## TOTAL FILTER USE

From the main menu, press ▼ twice. Press 3 to display the total filter use. Press 2 to reset.

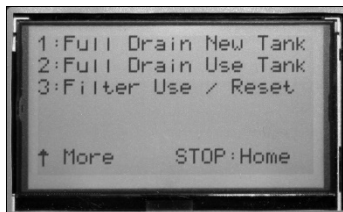

## FILTER CHANGE DUE

The machine will indicate when the canister filters need to be replaced. Use a standard filter band clamp tool to unscrew old filters, and replace them with new filters. Make sure new filters are on tight.

**IMPORTANT:** Machine must be primed after filter change.



## POWER FAILURE MEMORY

If there is a power failure during a fluid exchange, the procedure can be continued seamlessly.

Simply reconnect the battery cables and press the **Green Button**. The exchange will resume where it left off.

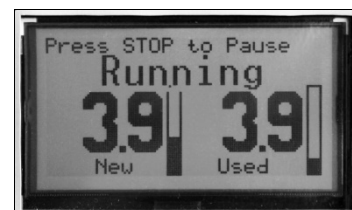
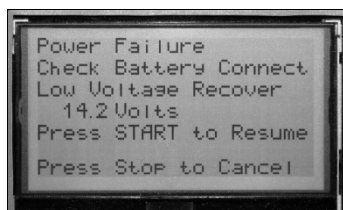

## CYCLE VALVES

From the main menu, press ▼ to proceed to the next menu. Press 9 to cycle the valves.

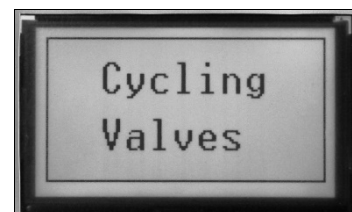



## IV. TROUBLESHOOTING & MAINTENANCE

### 4.01 COMMON PROBLEMS / SOLUTIONS

**Problem:** "Power Failure" screen displays

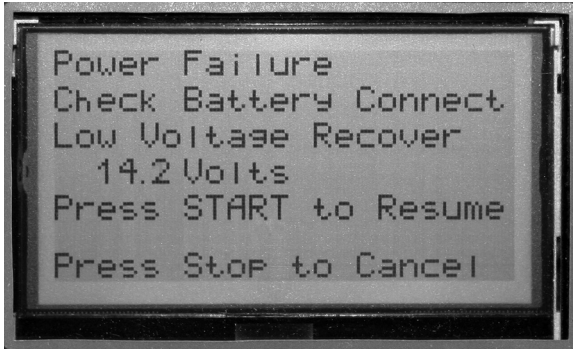

**Solution 1:** Check battery connection. Make sure there are no loose connections, and the machine's battery clips are not reversed. Remove all corrosion from the battery terminals. Make sure vehicle's A/C system is turned off.

**Solution 2:** The vehicle's battery is not putting out enough voltage to run the machine. Connect the machine to a better 12V power source. Stand-alone shelf batteries will not work.

### 4.02 MAINTENANCE PROCEDURES

• **Replace Canister Filters (Part#: 940796A) when machine prompts you to do so:**

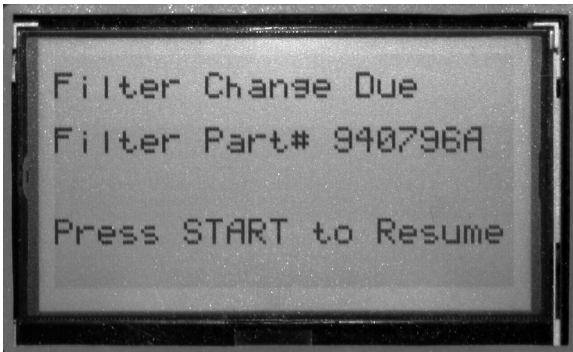

*Use a standard filter band clamp tool to unscrew old filters, and replace them with new filters. Make sure new filters are on tight.*

• **Clean Waste Fluid Screen (Located in bottom of recessed hose tray area)**

*This helps eliminate surface tension caused by debris and contamination from the air. Using a sharp pick, remove screen. Clean using degreaser and brush, and blow out with air compressor.*

• **Periodically Wipe Down Exterior using a soft, damp cloth.**

## V. REPLACEMENT PARTS

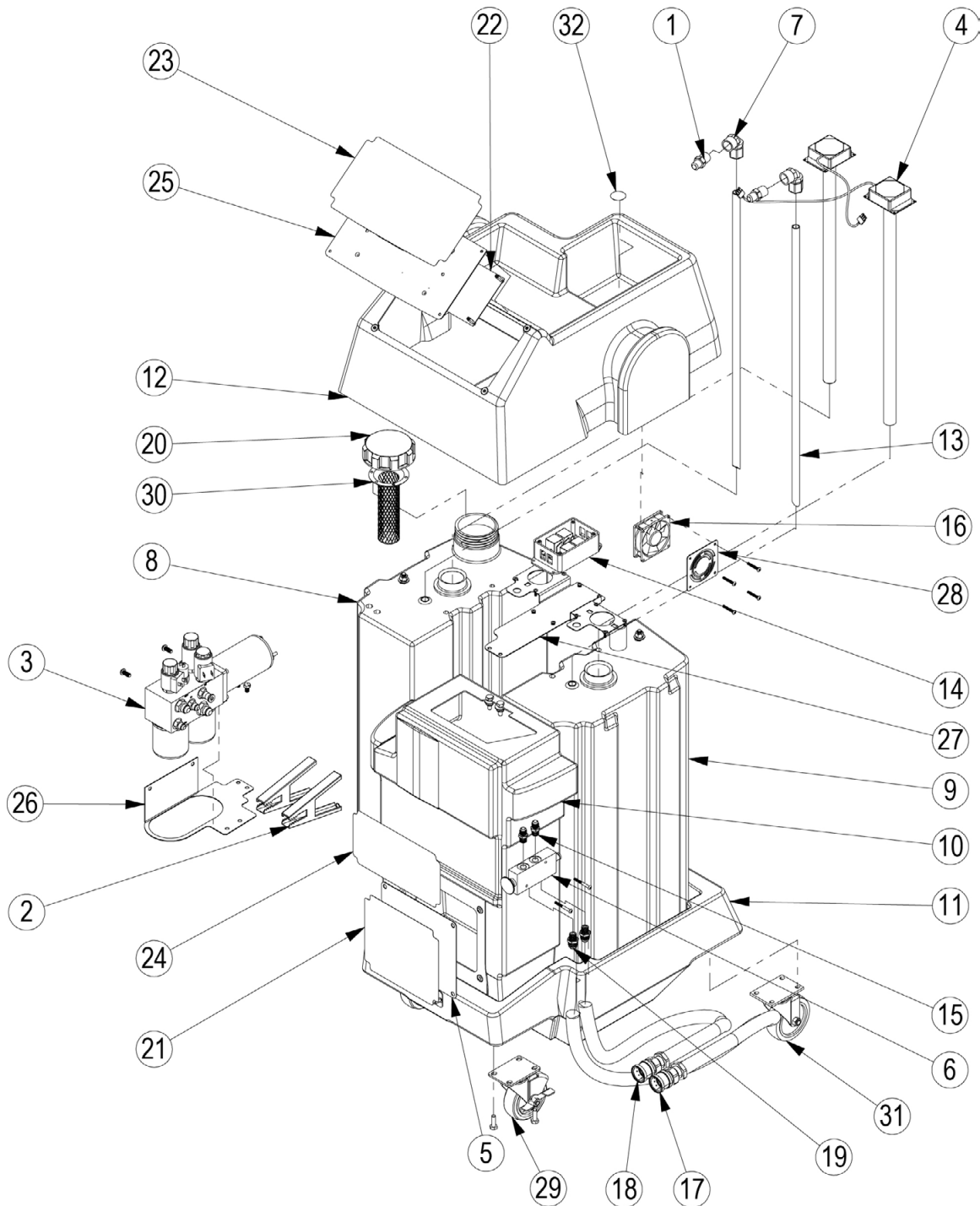

ITEM NO.	PART NO.	DESCRIPTION	QTY.
1	940125	MALE CONNECTOR 1/2 NPT 1/2 JIC	2
2	940307	6GA BATTERY CABLES 16 FT	1
3	940468	MANIFOLD W/R PUMP NO PRO PORT	1
4	940469	FLUID LEVEL SENSOR SNAP ON	2
5	940921	SERVICE PANEL-BLK-TS MACH	1
6	941099	FLOW DIVERTER VALVE-HIGH FLOW	1
7	941226	ELBOW PLASTIC FEM 1/2NPTX5/8TU	2
8	941600	NEW FLUID TANK-RED PROMAX	1
9	941601	USED FLUID TANK-RED PROMAX	1
10	941602	CONSOLE-BLACK PROMAX	1
11	941603	CHASSIS-BLACK PROMAX	1
12	941604	TOP-BLACK	1
13	941613	TUBE-ALUM 5,8OD X 27.5 MITER	2
14	941617W	MOTOR CONTROL BOX	1
15	941621	FITTING - 6 SAE X 3/8 JIC 6-F50X-S	2
16	941655W	COOLING FAN ONLY TSD/PROMAX	1
17	941656	SERVICE HOSE (RED) LARGE FITTING	1
18	941657	SERVICE HOSE (BLACK) LARGE FITTING	1
19	941658	ADAPTER 6SAE X 1,2 MALE JIC	2
20	942113	TANK CAP	1
21	943079	OVERLAY-SERV PANEL UNIV TS700	1
22	40200740	ELECTRONIC BOARD - TRANS MACHINES	1
23	40201206	OVERLAY CONTROL PANEL - PROMAX40 LCD	1
24	40201207	OVERLAY SERVICE PANEL - PROMAX40 LCD	1
25	40300391	PROMAX LCD CONTROL PANEL	1
26	P941611	MANIFOLD BRKT-BLACK PROMAX	1
27	P941612	SENSOR BRACKET-BLACK PROMAX	1
28	P941616	COOLING FAN COVER BLACK	1
29	R942118	CASTER 4 W/BRAKE ATFX	2
30	R942129	SCREEN BASKET AH6INBSKT	1
31	R942137	CASTER 4 SWIVEL ATFX	2
32	R942150	STAINLESS SCREEN DISCS-USED FLUID	1

## LIMITED ONE (1) YEAR WARRANTY

### Flo-Dynamics ProMax40

Flo-Dynamics warrants only to the original Purchaser that under normal use, care and service, the Equipment (except as otherwise provided herein) shall be free from defects in material and workmanship for one year from the date of original invoice. External hoses, remote control modules, adapters and all other attachments, supplies and consumables (except as otherwise provided herein) are warranted for 90 calendar days from the date of original invoice. Filter elements are not warranted. Printed circuit boards purchased from, but not installed by Seller are not warranted.

**SELLER'S OBLIGATIONS UNDER THIS WARRANTY ARE LIMITED SOLELY TO THE REPAIR OR, AT SELLER'S OPTION, REPLACEMENT OF EQUIPMENT OR PARTS WHICH TO SELLER'S SATISFACTION ARE DETERMINED TO BE DEFECTIVE AND WHICH ARE NECESSARY, IN SELLER'S JUDGEMENT, TO RETURN THE EQUIPMENT TO GOOD OPERATING CONDITION. NO OTHER WARRANTIES EXPRESS OR IMPLIED OR STATUTORY, INCLUDING WITHOUT LIMITATION ANY IMPLIED WARRANTY OF MERCHANTABILITY OR FITNESS FOR A PARTICULAR PURPOSE, SHALL APPLY AND ALL SUCH WARRANTIES ARE HEREBY EXPRESSLY DISCLAIMED.**

This warranty does not cover (and separate charges for parts, labor and related expenses shall apply to) any damage to, malfunctioning, inoperability or improper operation of the Equipment caused by, resulting from or attributable to (A) abuse, misuse or tampering; (B) alteration, modification or adjustment of the Equipment by anyone other than Seller's authorized representatives; (D) improper or negligent use, application, operation, care, cleaning, storage or handling; (E) fire, water, wind, lightning or other natural causes; (F) adverse environmental conditions, including, without limitation, excessive heat, moisture, corrosive elements, or dust or other air contaminants, radio frequency interference, electric power failure, power line voltages beyond those specified for the equipment, unusual physical, electrical or electromagnetic stress, and/or any other condition outside of Seller's environmental specifications; (G) use of the Equipment in combination or connection with other equipment, attachments, supplies or consumables not manufactured or supplied by Seller; or (H) failure to comply with any applicable federal, state or local regulation.

Repairs or replacements qualifying under this Warranty will be performed on regular business days during Seller's normal working hours within a reasonable time following Purchaser's request. **All requests for Warranty service must be made during the stated Warranty period.** This warranty is non-transferable

