

# Instruction Manual AME Intl. Part #11065



## **WARNING SAFETY PRECAUTION**

This product, as well as all Tire Tools, should never be used by persons unless they have been trained properly according to O.S.H.A. Regulation #29CFR 191.177 entitles "Servicing Single-Piece & Multiple Rim Wheels." Copy of Regulation is enclosed or contact this manufacturer



## **WARNING SAFETY PRECAUTION**

**THIS PRODUCT IS NOT INTENDED TO BE USED AS A LIFTING DEVICE**

2347 Circuit Way, Brooksville, FL 34604  
Phone (352) 799-1111 Toll Free (877) 755-4263 Fax (352) 799-1112  
Email: [sales@ameintl.net](mailto:sales@ameintl.net)



# Instruction Manual

## AME Intl. Part #11065

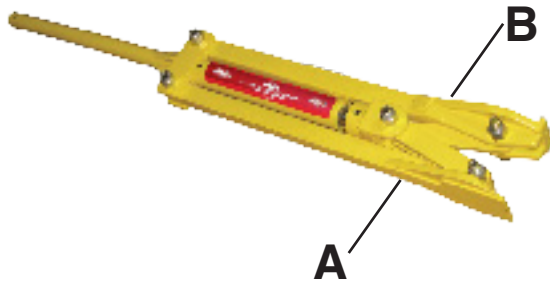

### TO OPERATE TOOL

1. Jack the tractor up until the duals are clear of the ground. Place jack stands under the axle of the tractor and lower the tractor onto the jack stands or cribbing.

### DO NOT WORK ON TIRE/WHEEL ASSEMBLY WITHOUT JACK STANDS OR APPROVED CRIBBING.

2. Deflate outside dual and evacuate any ballast that might remain in the tire.
3. Place the 11065 tool between the duals. The 11065 tool only needs 4 1/2" of space to operate and extends up to 12". Place the drive arm (A) faced toward the inside bead of the outside dual, place the tip of the tool against the side wall of the tire as close to the rim lip as possible.

### CAUTION: DO NOT PUT THE DRIVE SPADE (A) OF THE TOOL AGAINST THE RIM.

4. Apply a small amount of pressure with the hydraulic pump, just enough to allow the (B) lip arm of the tool to contact the rim flange of the inside dual.

### CAUTION: USE THE LONG HANDLE TO AVOID PINCH POINTS AND RELEASING COMPONENTS DURING OPERATION AND RETRACTION.

5. Keep applying pressure with the hydraulic pump until the bead separates from the rim.
6. Rotate the tire in small increments and repeat steps # 3, # 4, and # 5 until the bead is separated from the rim.



# PARTS BREAKDOWN

## Parts List For

Dual Agricultural 300 Tire Bead Breaker

11065

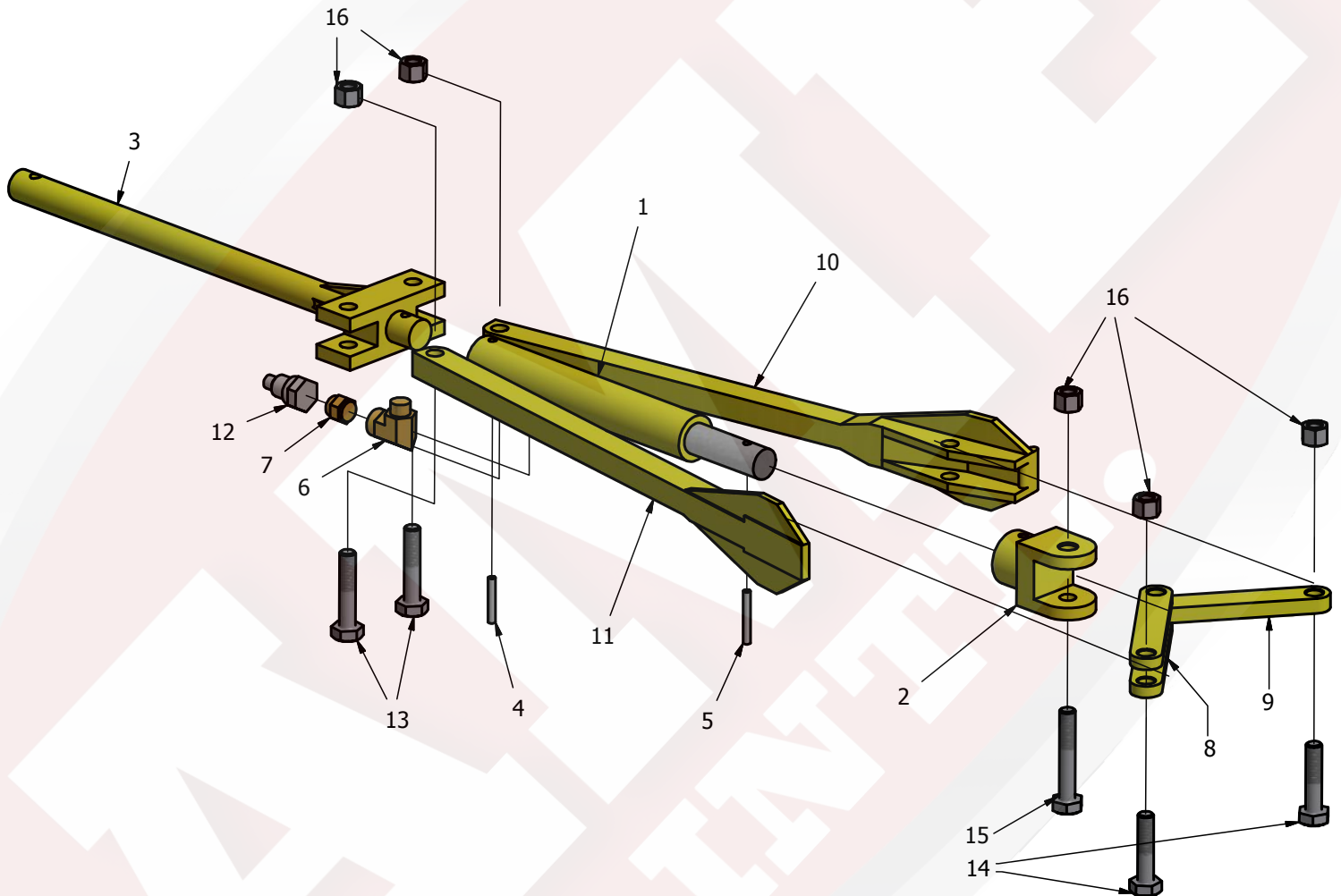



# PARTS BREAKDOWN

## Parts List For

Dual Agricultural 300 Tire Bead Breaker

11065

Item	Part No.	Stock No.	Qty	Description
1	11065-001	70731611	1	Ram-AME Bead Breaker
2	11065-002	N/A	1	Clevis-AME Bead Breaker
3	11065-003	70142723	1	Handle-AME Bead Breaker
4	11065-004	N/A	1	Roll Pin .25x1.50
5	11065-005	N/A	1	Roll Pin .25x1.75
6	11065-006	N/A	1	Elbow-Street STL .38x90 DEG
7	11065-007	72053723	1	Adapter-MPT/Hex/MPT .38 .38
8	11065-008	70142726	2	Pivot Arm-AME Bead Breaker 0.38
9	11065-009	70142727	1	Pivot Arm-AME Bead Breaker 0.5
10	11065-010	70142724	1	Arm-Dual Bead Breaker (With Lip)
11	11065-011	70142760	1	Arm-Dual Bead Breaker (Flat)
12	11065-012	72053546	1	Nipple-Disc .38 FPT 10,000 PSI
13	11065-013	N/A	2	Cap Screw .50-13x2.50 HH GR8 Z
14	11065-014	72601368	2	Cap Screw .50-13x2.25 HH GR8 Z
15	11065-015	N/A	1	Cap Screw .50-13x3.00 HH GR8 Z
16	11065-016	72062080	5	Nut 0.50-13 Hex Nylock